

PX20

Low Lift Pallet Truck
2.000 kg

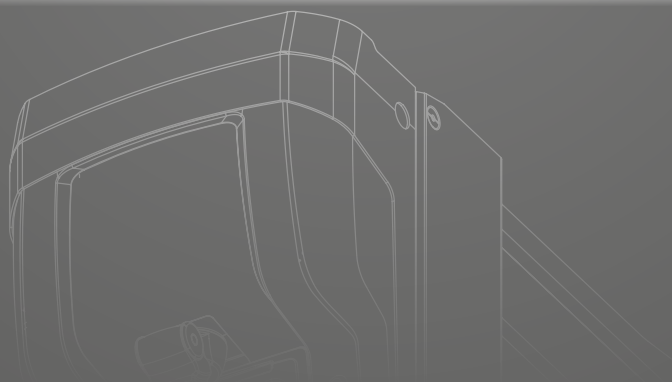
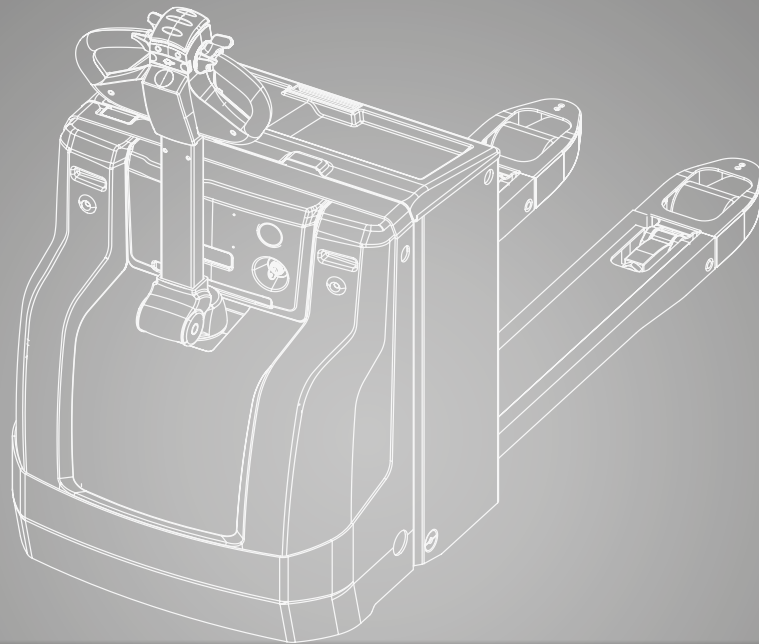

DIMENSIONS

PX20

A = Brake zone
B = Drive zone

$$R_h = \sqrt{x^2 + \left(\frac{b_{12}}{2}\right)^2}$$

$$A_{st} = W_a + l_6 - x + a \quad \text{if } R_h < W_a$$

$$A_{st} = R_h + l_6 - x + a \quad \text{if } R_h > W_a$$

For corresponding data see Specification Chart.

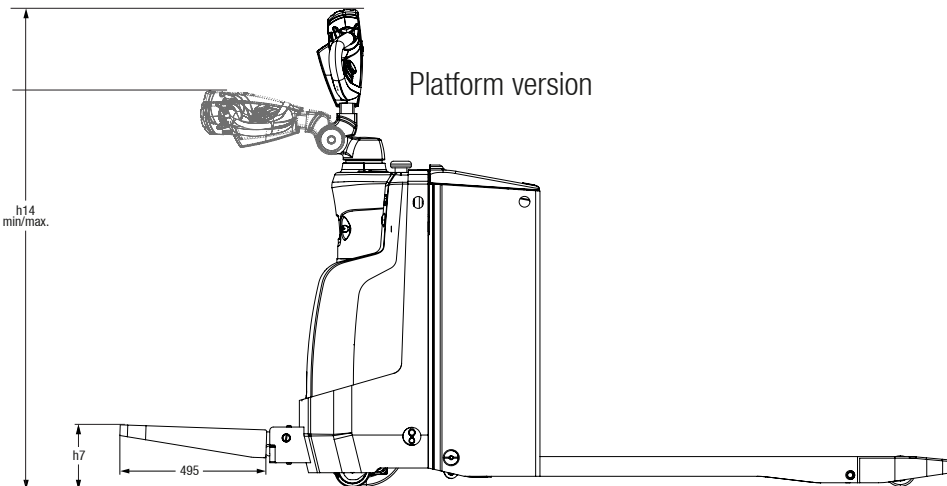
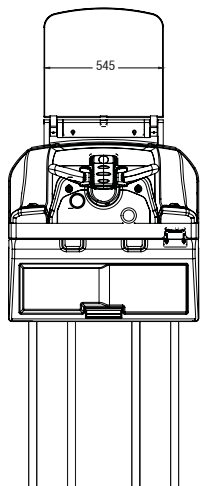
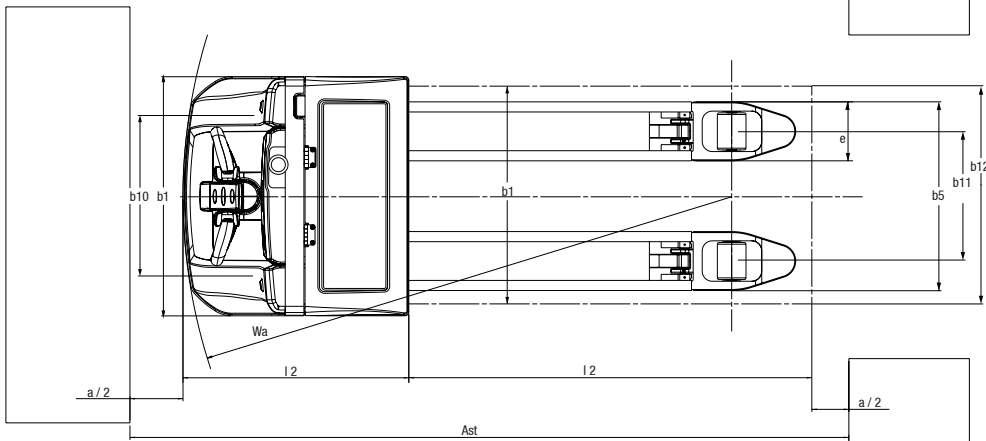
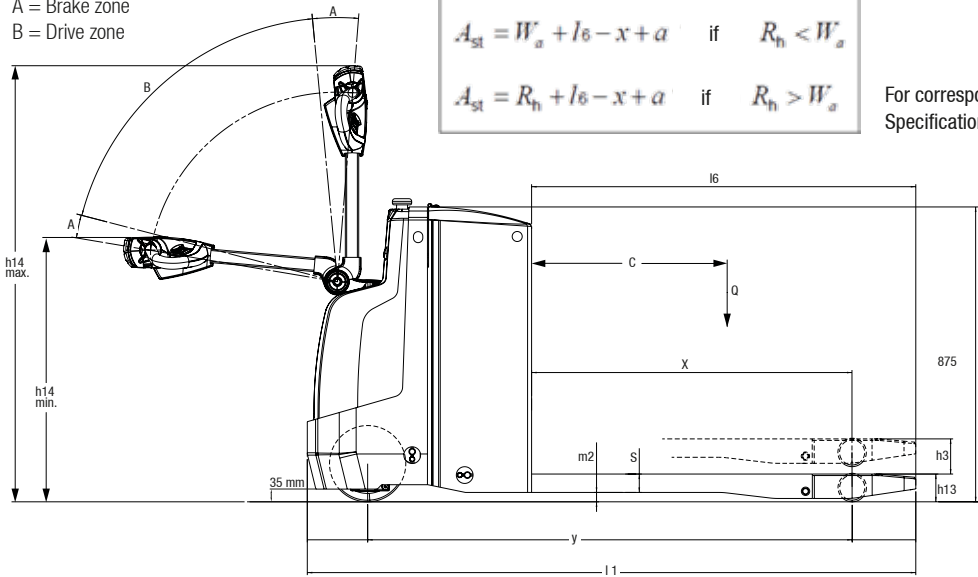

SPECIFICATIONS

Product Specification acc. to VDI 2198

1.1 Manufacturer (Abbreviation)		CLARK	
Specifications	1.2 Manufacturer's designation	PX20	
	1.3 Drive	24V Electric	
	1.4 Operator type	Pedestrian	
	1.5 Rated capacity/rated load	Q (kg)	2000
	1.6 Load centre distance	c (mm)	600
	1.8 Load distance	x (mm)	1005
	1.9 Wheelbase	y (mm)	1356
	Weight	2.1 Service weight incl. battery (see 6.5)	kg
2.2 Axle loading, laden front/rear		kg	855 / 1660
2.3 Axle loading, unladen front/rear		kg	407 / 108
Tyres, Chassis	3.1 Tyres		Polyurethane
	3.2 Tyre size, front		Ø 230 x 82
	3.3 Tyre size, rear		Ø 85 x 110 / Ø 85 x 70
	3.4 Additional wheels (dimensions)		Ø 100 x 40
	3.5 Wheels, number front/rear (x = driven wheels)		1 x + 2 / 2 / 4
	3.6 Tread, front	b10 (mm)	490
	3.7 Tread, rear	b11 (mm)	385
Dimensions	4.4 Lift	h3 (mm)	130
	4.4 Lift height	h3 + h13 (mm)	215
	4.8 Stand height	h7 (mm)	160
	4.9 Height tiller in driving position min./max.	h14 (mm)	796 / 1219
	4.9 Height tiller in driving position min. / max. (w / platform)	(mm)	1066 / 1290
	4.15 Height, lowered	h13 (mm)	85
	4.19 Overall length (without platform)	l1 (mm)	1692
	4.20 Length to face of forks (without platform)	l2 (mm)	532
	4.21 Overall width	b1 (mm)	710
	4.22 Fork dimensions	s • e • l (mm)	55 x 175 x 1150
	4.25 Distance between fork-arms	b5 (mm)	560
	4.32 Ground clearance, centre of wheelbase	m2 (mm)	28
	4.33 Aisle width for pallets 1.000 x 1.200 sideways	Ast (mm)	1731
4.34 Aisle width for pallets 800 x 1.200 lengthways	Ast (mm)	1931	
4.35 Turning radius	Wa (mm)	1536	
Performance	5.1 Travel speed, laden/unladen	km/h	6.0 / 6.0
	5.2 Lift speed, laden/unladen	m/s	0.04 / 0.05
	5.3 Lowering speed, laden/unladen	m/s	0.05 / 0.05
	5.8 Max. gradeability, laden/unladen *1	%	8 / 20
	5.10 Service brake		Electric
Electrics	6.1 Drive motor rating S2 60 min	kW	1.2
	6.2 Lift motor rating at S3 15 %	kW	1.2
	6.3 Battery acc. to DIN 43531/35/36 A, B, C, no		Option
	6.4 Battery voltage/nominal capacity (5hr)	V/Ah	24V / 150 (250 / 375 Ah)
	6.5 Battery weight	kg	151
	6.6 Energy consumption acc. to VDI cycle	kWh/h	-
	- Battery type		Traction battery
	8.1 Type of drive unit		AC
Misc.	10.5 Steering design		Mechanical
	10.7 Sound pressure level at the driver's seat acc. to EN 12053	dB(A)	63

*1) At friction coefficient $\mu=0.6$ with 1.6 km/h

All data refer to trucks in standard design.

Performance may vary + 5 % and - 10 % due to motor and system efficiency tolerance. The performance shown represents nominal values which may be obtained under typical operating conditions of a machine. CLARK products and specifications are subject to change without notice.

EQUIPMENT EXTRAS

		PX20
General	Reliable low - maintenance AC traction motor	•
	Two suspension castor wheels	•
	Load backrest	X
	Platform option	X
Drive and Battery Options	Travel speed 6 km / h	•
	Single load wheel (Polyurethane)	•
	Tandem load wheel (Polyurethane)	X
	Pallet entry wheels	X
	Integrated on - board charger	X
	Battery discharge indicator	•
	Side battery removal (PX20 only with 375 Ah battery)	X
	Battery compartment sizes: 150 Ah or 250 Ah batteries	•
Miscellaneous	Optional fork length	X
	Backup alarm	X
	Crawl speed switch	X
	Push button for operation with vertical tiller	X
Safety	Key switch activation	•
	Pin-code activation	X
	Automatic lift stop at max. lift	•
	Automatic parking brake	•
	Comfort and safety tiller	•
	Control of all drive commands left - and right - handed	•

• = Standard Equipment; x = Option

FEATURES & ADVANTAGES

PX20

The CLARK PX range includes three low lift truck models. The PX20 which is an extremely robust low lift truck has a maximum speed of 6 km / h. As an option it comes with an extra operator platform. The PPX20 model with a maximum speed of 8.5 km / h and the PPXS20 12km / h are equipped with power steering and an operator platform as standard. The CLARK PX range has been designed for the most demanding applications over long transportation distances. The platforms can be manually folded to increase manoeuvrability in confined spaces.

Performance & Safety

- Powerful acceleration with AC technology.
- Battery capacity up to 375 Ah.
- Automatic stop on gradients and ramps (automatic parking brake).
- Automatic braking when the tiller handle is released.
- Ergonomic safety tiller arm.
- Side battery removal allows for multiple shift rotation applications. (Option for the PX20 only with a large battery compartment)

Reliability & Servicing

- Error code display in display.
- Reliable AC controller.
- One piece front cover for easy access during service and maintenance work.
- Steel fabricated battery cover (PX20).

Safety & Ergonomics

- Sensitive drive switch for safe and precise work.
- Suspension support wheel for greater stability.
- Tiller head integrated drive and operating switches with easy reach positions.
- Clearly positioned battery discharge indicator.
- Sloped battery cover for optimum fork view.
- Tiller handle crawl speed function (option).

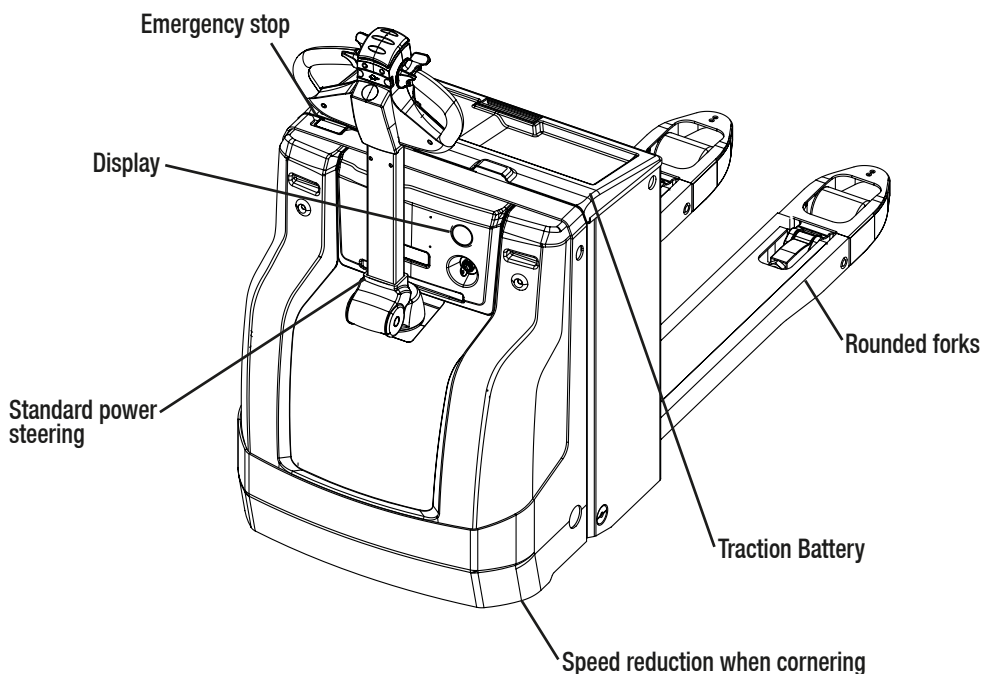

PRODUCT DESCRIPTION



The CLARK low lift pallet trucks PX20 and PPX(S)20 are robust value asset low lift trucks for industrial applications. These trucks are constructed following the Built To Last® principle. Whether for loading and unloading lorries or the transportation of heaving materials in a warehouse environment, the CLARK storage technology is designed for tough applications. These trucks can be fitted with batteries up to 375 Ah. The side battery removal system allows for multiple shift rotation applications.

Productivity

All operation functions for lifting, lowering and driving are positioned in an ergonomic safety tiller handle with easy to reach switches. This allows the operator to concentrate solely on the conveyance process.

With the tiller arm in the vertical position, by using an optional switch the truck can be used for manoeuvring in confined spaces.

Reliability

The PX20 / PPX(S)20 range is the result of CLARK's rich history as a developer and manufacturer of robust, reliable and long-lasting forklifts following the Built To Last® principle.

For the construction of the PX / PPX(S) range, CLARK used proven component materials and a sound build to ensure a long useful life, high performance and safety.

Battery compartment and Charging Technology

The robust mono-piece frames are available in different configurations. Three different battery compartment sizes are available for the PX20:

- Battery compartment (small) for 150 Ah
- Battery compartment (medium) for 250 Ah
- Battery compartment (large) for 375 Ah

Even more flexible usage with optional integrated charger for the PX20 using a standard power socket.

The side battery removal option is also available in combination with a large battery compartment.

The PPX(S)20 range has two available battery size compartments:

- Battery compartment (standard) for 225 Ah or 250Ah
- Battery compartment (large) for 375 Ah

Optional PIN Code Activation (PX20)

With a four-digit PIN, the PX20 can be activated without an ignition key. Programmable automatic shutdown function also prevents unauthorised usage.

Driving characteristics such as acceleration, maximum speed or braking response can be set individually for each PIN code (up to 25 PIN codes can be saved with different driving parameters) and allows the PX20 to be adapted to the most diverse requirements.

Operator Platform

The foldable operator platform, an optional extra for the PX20 and standard for the PPX(S)20 increases both safety and comfort.

The platform has a heavy duty textured and non-slip surface and provides optimum comfort and additional suspension. The low level standing height makes it easy to get on and off the unit during operation.

If the driver steps off the platform, the unit automatically switches to standby mode and the unit can no longer be operated.

TotalTruck@TotalTruck.dk / www.lagereksperten.dk

CLARK Europe GmbH

Dr.-Alfred-Herrhausen-Allee 33
47228 Duisburg / Germany
Tel.: +49 (0)2065 499 13-0
Fax: +49 (0)2065 499 13-290

E-Mail: Info-europe@clarkmheu.com
www.clarkmheu.com

Dealer:



TotalTruck A/S

CVR-nr. DK 26 12 66 22

Lucernetofte 5 · 5550 Langeskov

Tlf. +45 70 27 99 88

Nr.: 4583089 06/2022

Valid for Lot-no.: PX20: 9831